



LW35-72.5 六氟化硫断路器 LW35-72.5 SF₆ CIRCUIT BREAKER

LW35-72.5 SF₆ 断路器采用自能式灭弧原理，利用灭弧室内电弧自身的能量在一定时间内熄灭电弧。LW35-72.5 断路器采用弹簧机构，可实现三相联动。产品的设计制造均符合国标及 IEC 相关标准的要求。

- 原理先进，结构紧凑，额定参数高
- 全弹簧操作机构，免维护
- 易安装，噪音低，可靠性高
- 双密封结构，SF₆ 气体年漏气率最小

LW35-72.5 SF₆ circuit breaker is designed with self-energizing theory that the arc generated in the interrupter is distinguished at a specified time with a part of energy from the arc itself. LW35-72.5 circuit breaker is three-phase gang operation with a spring mechanism. The circuit breaker is designed and manufactured in accordance with latest IEC standards.

- Advanced design principle, compactness, high rated parameters
- Maintenance-free and pure-spring drive
- Easy installation, low noise, high reliability
- Double sealing system, minimum SF₆ gas leakage



★ 环境条件

- 环境温度：-40℃ ~ +50℃
- 风压：≥ 700pa
- 污秽等级：III, IV 级
- 海拔高度：≤ 3000m (可根据要求调整)

★ Service Conditions

- Ambient temperature: -40℃ ~ +50℃
- Wind pressure: ≥ 700pa
- Pollution level: III, IV
- Altitude: ≤ 3000m(Higher altitudes on request)

主要技术参数 / Main Technical Parameters

项目 Item		单位 Unit	参数值 Data
额定电压 Rated voltage		kV	72.5
操作方式 Operation mode			三相联动 3-phase gang operation
额定电流 Rated current		A	3150
额定频率 Rated frequency		Hz	50
额定短路开断电流 Rated short circuit breaking current		kA	40
额定短时耐受电流 Rated short time withstand current (3s)		kA	40
近区故障开断电流 Short line fault breaking current		kA	30/36
额定峰值耐受电流 Rated peak withstand current		kA	100
额定失步开断电流 Rated out-of-phase breaking current		kA	10
额定线路充电开断电流 Rated line charging breaking current		A	10
额定 SF ₆ 气体压力 (20℃时) Rated SF ₆ gas pressure (at 20℃)		MPa	0.4
主回路电阻 Main loop resistance		μΩ	≤ 40
操作顺序 Operation sequence			O-0.3s-CO-180s-CO or O-0.3s-CO-15s-CO
机械寿命 Mechanical endurance		次 Times	10000
SF ₆ 气体年漏气率 Annual leakage of SF ₆ gas		%	≤ 1%
水分含量 (V/V) Moisture content (V/V)		PPm	150/300 (交接值 / 运行值) 150/300 (Pre-delivery/In service)
爬距 Creepage distance	断口间 Across the open contacts	mm	2300
	对地 To earth	mm	2300
绝缘水平 Insulation Level			
1 分工频耐受电压 (有效值, 干试, 湿试) 1min power frequency withstand voltage (r.m.s.) (dry/wet)	相间 / 相对地 Between phases/ phase to earth	kV	140
	断口间 Across the open contacts	kV	140
雷电冲击耐受电压 (峰值) (全波 1.2/50 μs) Lightning impulse withstand voltage (full wave 1.2/50 μs) (peak)	相间 / 相对地 Between phases/ phase to earth	kV	325
	断口间 Across the open contacts	kV	325



主要技术参数 / Main Technical Parameters

项目 Item	单位 Unit	参数值 Data	
SF ₆ 气体零表压时, 5 分工频耐受电压 5min power frequency withstand voltage at 0 MPa SF ₆ pressure	相间 / 相对地 Between phases/ phase to earth	kV	55
	断口间 Across the open contacts	kV	55
SF₆ 气体压力 (20℃) 参数 SF₆ Gas Pressure (at 20℃)			
额定工作压力, P _N Rated working pressure, P _N	MPa	0.4 ± 0.015	
补气报警压力, P ₁ Pre-filled gas alarming pressure, P ₁	MPa	0.35 ± 0.015	
最低功能压力, P ₂ Min. service gas pressure, P ₂	MPa	0.33 ± 0.015	
产品包装运输时充气压力, P ₃ Filled pressure for transport, P ₃	MPa	0.025	
控制回路参数 Parameters for Control Circuit			
控制回路及信号回路电压 Control and signal circuit voltage	V	DC110/DC220	
机电电压 / 功率 / 电流 Motor voltage/power/current	V/W/ A	DC/AC110/750/6.8 or DC/ AC220/750/3.4	
加热器电压 / 功率 Heater voltage/ power	V/W	AC220/100	
分合闸线圈电压 / 电流 Opening/closing coil voltage/current	V/A	DC110/4.3, DC220/2.0	
分合闸线圈电阻 Opening/closing coil resistance	Ω	25.5 (DC110V), 110 (DC220)	
额定电压下储能时间 Storage energizing time at rated voltage	s	≤ 15	
机械特性参数 Mechanical Parameters			
分闸时间 Opening time	ms	27 ± 3	
合闸时间 Closing time	ms	100 ± 20	
合 - 分闸时间 C-O time	ms	≤ 50 (出厂试验时 at routine test), 55 ± 5 (运行时 at service)	
分 - 合闸时间 O-C time	ms	≤ 300 (出厂试验时 at routine test), 300 (运行时 at service)	
分闸同期 Time interval between opening of first and last phase	ms	≤ 3	
合闸同期 Time interval between closing of first and last phase	ms	≤ 5	
全开断时间 Breaking time	ms	≤ 60	

LW35-72.5 SF₆ 断路器外形图 Outline Drawing Of LW35-72.5 SF₆ Circuit Breaker

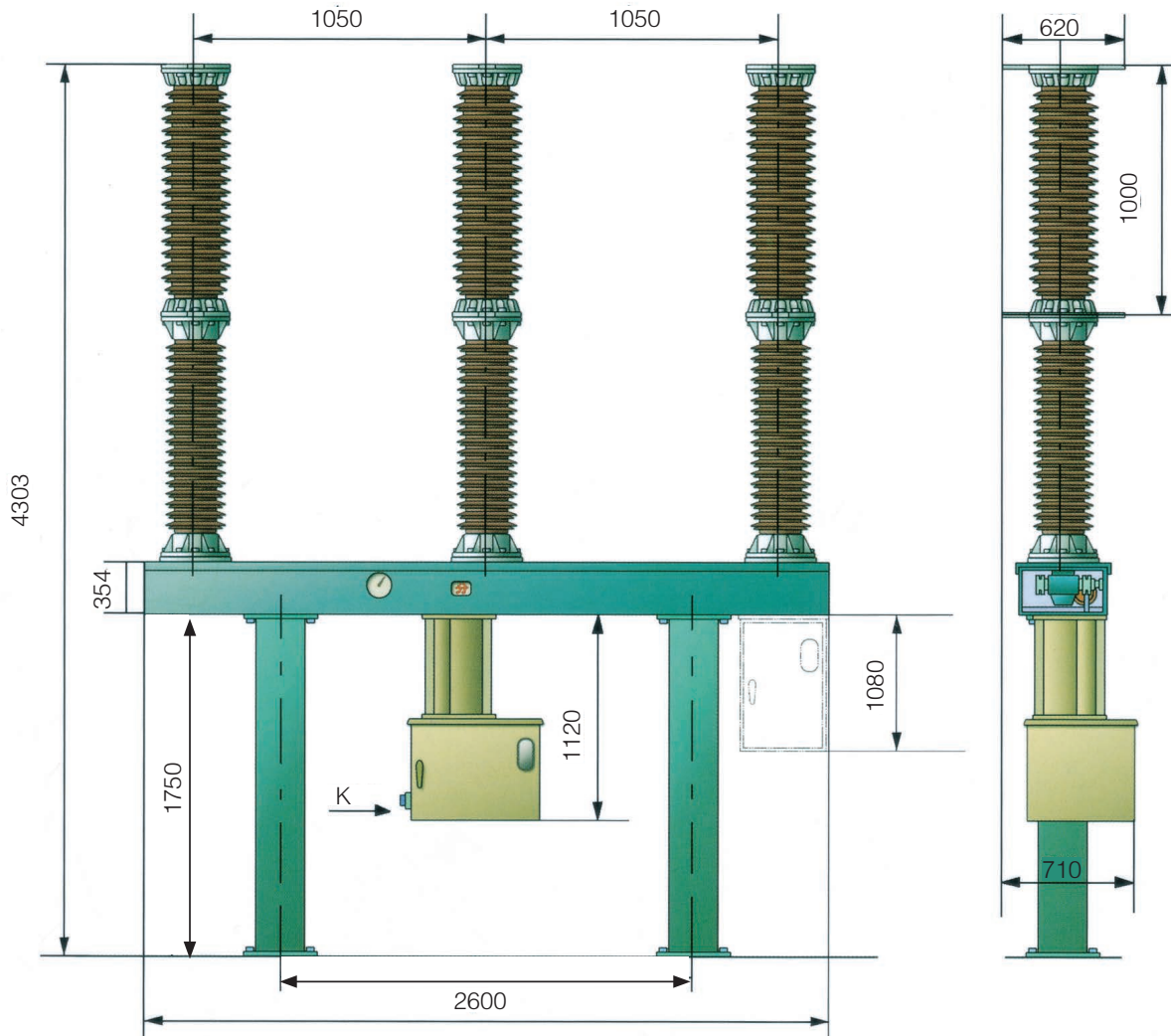

地址：中国·河南·平顶山市南环东路 22 号
邮编：467001
销售热线：86-375-3506733
售后热线：86-375-3506746
传真：86-375-3933897
网址：<http://www.pinggaogroup.com>

ADD: 22 Nanhuandong Road, Pingdingshan City,
Henan Province, P.R.China,467001
TEL: 86-375-3506733
FAX: 86-375-3933897
HTTP: www.pinggaogroup.com.cn